



U.S. PACKAGING EQUIPMENT, LLC

VacuMove

VERSATILE VACUUM LIFTER



Smart Lifting

VacuMove - The Flexible Lifter

VacuMove is the original vacuum lifter that lifts, lower, rotate and tilt loads using vacuum. Makes lifting easy and safe in all possible working conditions for both the operator and the product, in manufacturing and mechanical processing, warehouses and distribution centers.

VacuMove can handles almost any type of load. There are 12 models for lifting sacks and boxes, sheets, panels, crates, bales, drums and much more upto 600 lbs.

The extremely smooth and quick operation is accomplished by using the same handle to lift, lower and release the load and by using the vacuum to hold and lift the load.

Based on a unique concept, VacuMove has over the years been developed with the help of customers and VacuMove lifter users into a versatile and ergonomic system for simpler, safer and more effective lifting.

You easily get return on your investment; a two-man job can often be carried out by one operator with VacuMove. This lifting system is simple to adjust to suit loads and requirements of most industries. With VacuMove you achieve a combination of efficiency, ergonomics and economy that can not be matched by any other lifting system.

Model	VM80	VM100/120/140	VM160/180	VM200/230	VM250	VM300
Lifting capacity lbs	45	65/90/110	125/175	220/265	400	600

General Description

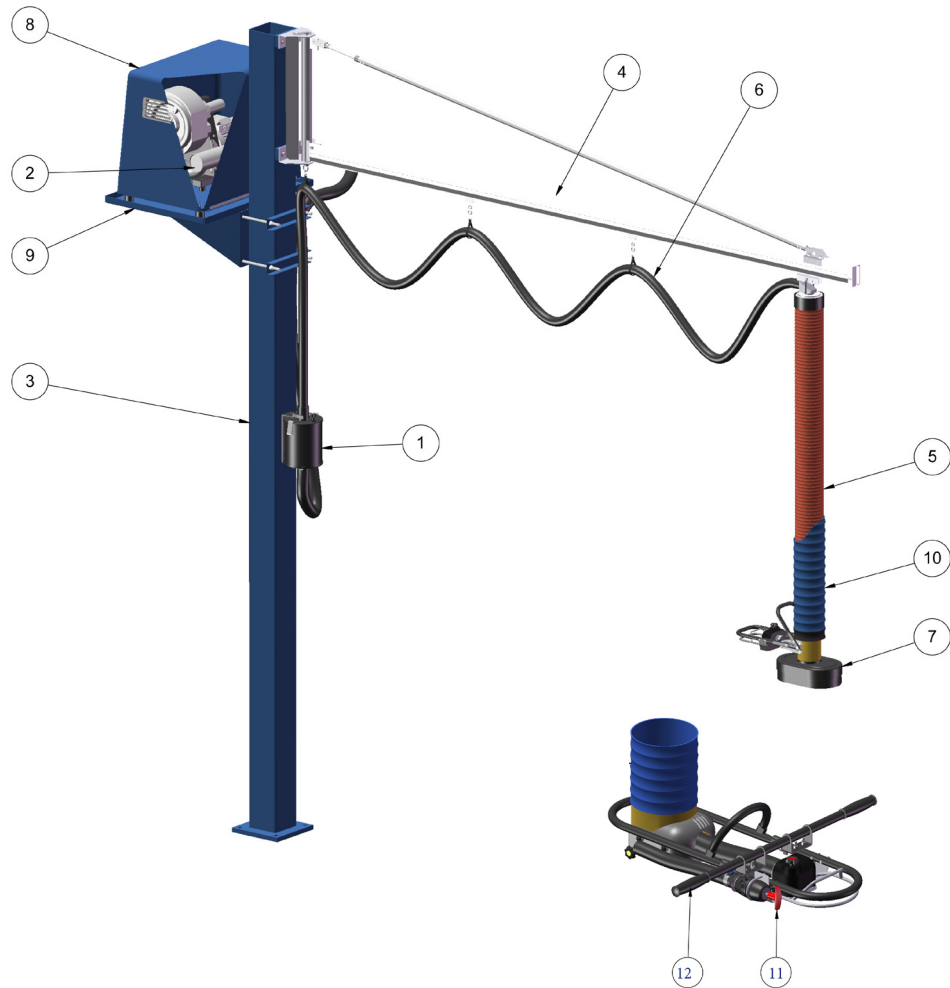

Standard	
No	Description
1	Air filter standard
2	Vacuum pump
3	Column for Lyftman jib arm
4	Jib arm
5	VacuMove vacuum lifter
6	Air tube
7	Suction foot
Options	
No	Description
8	Silencing hood
9	Pump shelf
10	Cover for vacuum lifter
11	Release valve
12	Cross bar

Installation Options

Suspend your VacuMove in our own range of Lyftman column Jib Cranes and Crane Systems in aluminum and steel. The lift arm or bridge crane suspends the lift tube and is available in different lengths and capacities.

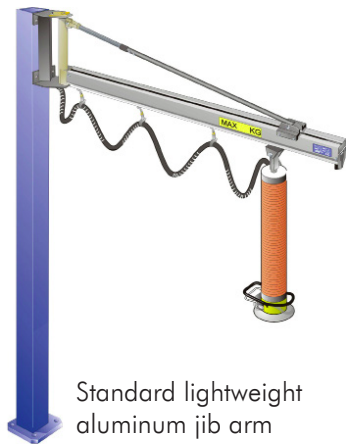

Standard lightweight aluminum jib arm

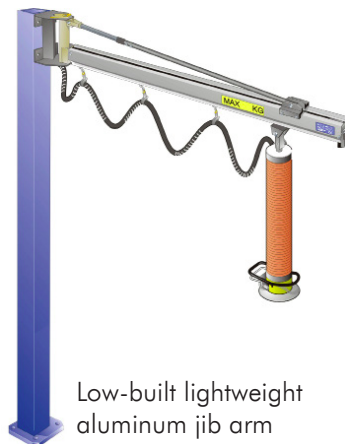

Low-built lightweight aluminum jib arm

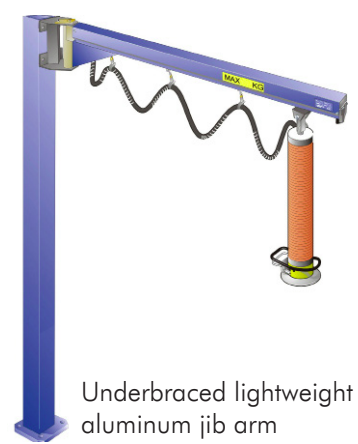

Underbraced lightweight aluminum jib arm

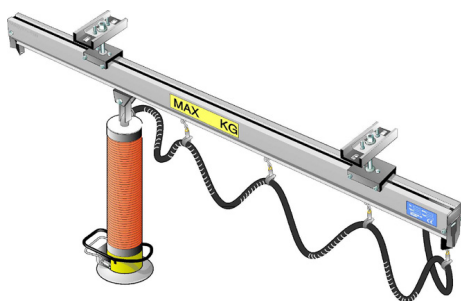

Lyftman monorail crane system. Optimal linear transportation.

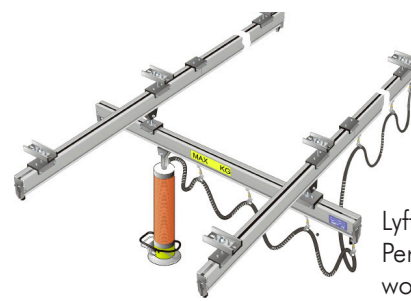

Lyftman crane system. Perfect for larger working areas.

Various Handle Options



Fixed handle



Fixed handle



Standard handle



Extended handle



Flex handle



Special handle

Vacuum Pumps

TAWI vacuum pums are high-performance, low consumption machines with long lifecycle. Silencing hood and shelf for vacuum pumps are optional accessories.

Pump unit	Power		Depression (mbars)	Weight (kg)	Tube model	Dimentions l x w x h (mm)
	@ 50 Hz (kW)	@ 60 Hz (kW)				
SA 200/2	1,1	1,3	720	49	VM 80	500x380x420
SA 320/2	2,2	2,55	550	34	VM 100 - 160	535x335x450
SA 350/2	3,0	3,45	630	41	VM 160 - 2180	630x335x450
SA 450/2	5,5	6,6	650	67	VM 160 - 2180	700x420x520



